

# CMT300

305mm max length  
11~25mm joint thickness

## Universal Dovetail Jig

Dovetail joints give a touch of craftsmanship to your work, but many woodworkers avoid these joints, because of their apparent complexity. CMT's new 305mm dovetail jig is the fast easy solution! Thanks to precise templates, permanent stops and easy adjustments, we have taken the "tinkering" out of dovetail joinery. Simply clamp your workpiece in with the edges against the factory-set stops, set your bit depth and then you are ready to rout. Rest assured, we haven't cut corners on quality either. This jig features a rugged steel body, templates, stops and clamping bars that together produce perfect long-lasting joints for all your woodworking needs. The jig accepts stock from 11mm to 25mm in thickness and is capable of crafting a variety of joints with the available templates. The jig comes with a template for 12.7mm half blind joints as well as a template guide. Optional templates are available for through dovetail and box joints.



### Standard equipment

- Standard Ø12,7mm silver blind template **CMT300-T128**
- Ø15,8x4mm template guide **899.005.00**

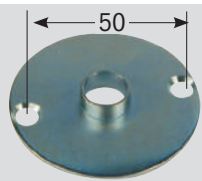

DESCRIPTION	ORDER NO.
Universal Dovetail Jig	<b>CMT300</b>

### IMPORTANT TIP



### HW DOVETAIL BITS (not included):

- 718.127.11** D=12,7mm A=14° S=6mm
- 818.128.11** D=12,7mm A=14° S=6,35mm
- 918.127.11** D=12,7mm A=14° S=8mm
- 818.628.11** D=12,7mm A=14° S=12,7mm

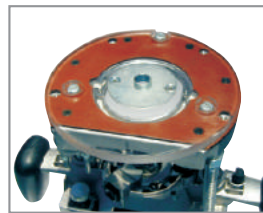

### Will the template fit my router?

Standard template guide attaches using two screws spaced 50mm on centre. Many routers are compatible with this design. However, if yours is not, choose from the list of universal routers here below:

### Universal router bases

- For Ø8 and Ø12mm shank
- For Ø6,35 and Ø12,7mm shank
- Prebored router plate for CMT7E and CMT8E

### ORDER NO.

- CMT300-SB1**
- CMT300-SB2**
- CMT300-SB**

### Here's how it works:

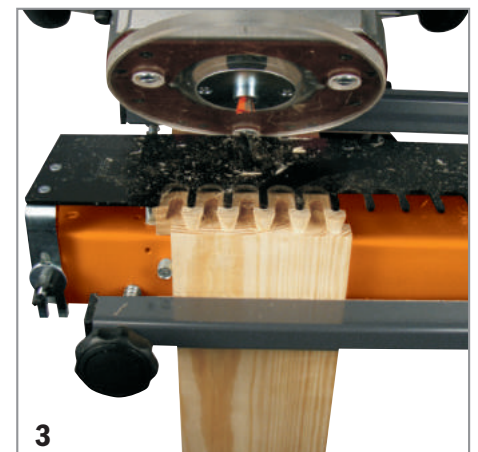

1

2

3

## Half Blind Template **CMT300-T064**

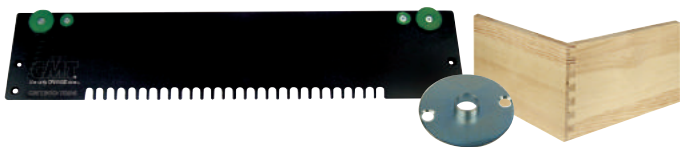

TEMPLATE LENGTH mm	DOVETAIL SIZE mm	THICKNESS mm	COLOUR	ORDER NO.
300	6,3	8 ~ 12	green	<b>CMT300-T064</b>

Supplied with Ø7,8x4mm precision guide

To be used with CMT dovetail router bits:  
 Ø6x8mm HW bit (Ø6mm shank)  
 Ø6,35x8,3mm HW bit (Ø6,35mm shank)



**899.003.00**  
  
**718.060.11**  
**818.064.11**

## Box Joint Templates **CMT300-T080 - CMT300-T127**

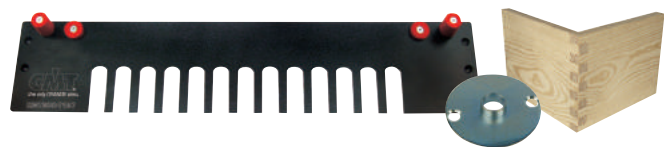

TEMPLATE LENGTH mm	DOVETAIL SIZE mm	THICKNESS mm	COLOUR	ORDER NO.
300	8	8 ~ 20	blue	<b>CMT300-T080</b>

Supplied with Ø11,1x4mm precision guide

To be used with CMT straight router bits:  
 Ø8x25mm HW bit (Ø6,35mm shank)  
 Ø8x30mm HW bit (Ø8mm shank)



**899.004.00**  
  
**811.081.11**  
**912.080.11**

TEMPLATE LENGTH mm	DOVETAIL SIZE mm	THICKNESS mm	COLOUR	ORDER NO.
300	12,7	8 ~ 20	red	<b>CMT300-T127</b>

To be used with CMT straight router bits:  
 Ø12,7x30mm bit HW (Ø6,35mm shank)  
 Ø12,7x30mm bit HW (Ø8mm shank)  
 Ø12,7x25mm bit HW (Ø12,7mm shank)



**812.127.11**  
**912.127.11**  
**811.627.11**

## Through Dovetail Templates **CMT300-T129 - CMT300-T190**

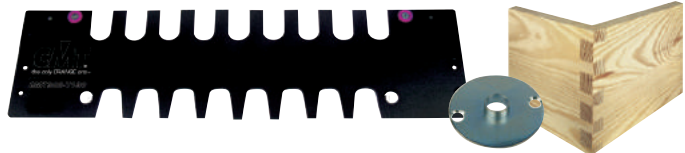

TEMPLATE LENGTH mm	DOVETAIL SIZE mm	THICKNESS mm	COLOUR	ORDER NO.
300	12,7	8 ~ 20	brown	<b>CMT300-T129</b>

Supplied with Ø11,1x4mm precision guide

To be used with CMT straight router bits:  
 Ø8x25mm HW bit (shank Ø6,35mm)  
 Ø8x30mm HW bit (shank Ø8mm)



**811.081.11**  
**912.080.11**

To be used with CMT dovetail router bits:  
 Ø12,7x20mm HW bit (Ø6,3mm shank)  
 Ø12,7x20mm HW bit (Ø8mm shank)

**818.129.11**  
**918.129.11**

TEMPLATE LENGTH mm	DOVETAIL SIZE mm	THICKNESS mm	COLOUR	ORDER NO.
300	19	15 ~ 22	violet	<b>CMT300-T190</b>

Supplied with Ø22x4mm precision guide

To be used with CMT straight router bits:  
 Ø12,7x30mm HW bit (Ø6,35mm shank)  
 Ø12,7x30mm HW bit (Ø8mm shank)  
 Ø12,7x25mm HW bit (Ø12,7mm shank)



**812.127.11**  
**912.127.11**  
**811.627.11**

To be used with CMT dovetail router bits:  
 Ø19x22mm HW bit (Ø6mm shank)  
 Ø19x22mm HW bit (Ø6,35mm shank)  
 Ø19x22mm HW bit (Ø8mm shank)  
 Ø19x22mm HW bit (Ø12mm shank)  
 Ø19x22mm HW bit (Ø12,7mm shank)

**718.190.11**  
**818.190.11**  
**918.190.11**  
**918.690.11**  
**818.690.11**

### Precision guide for router:

DIAMETER	ORDER NO.
7,8 x 4mm	<b>899.003.00</b>
11,1 x 4mm	<b>899.004.00</b>
15,8 x 4mm	<b>899.005.00</b>
22 x 4mm	<b>899.006.00</b>
27 x 6mm	<b>899.008.00</b>
30 x 6mm	<b>899.007.00</b>

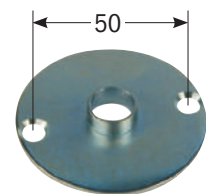

## Here are a few of the beautiful dovetail joints you can produce using CMT bits

Half blind

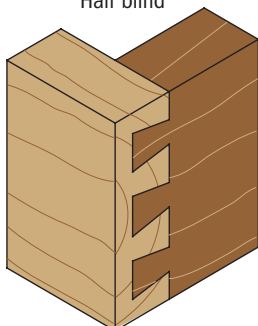

**CMT300 - T064**  
**CMT300 - T128 (INCLUDED with CMT300)**

Box joint

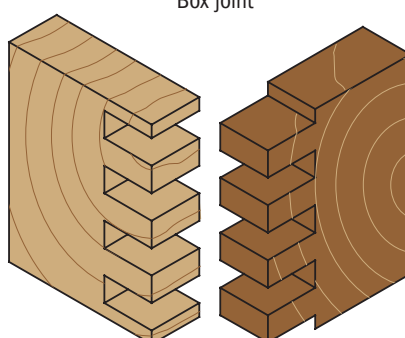

**CMT300 - T080**  
**CMT300 - T127**

Through dovetail

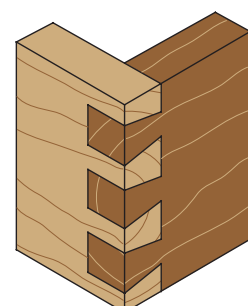

**CMT300 - T129**  
**CMT300 - T190**